

Important Notices

- DO NOT install the sensor in outdoor environment, unstable surface, or wet place.
- ONLY stick the sensor on a dry, clean, and flat surface.
- Keep the sensor away from magnetic or radio source.
- Change battery as soon as possible if you get low battery notification.

Frequently Asked Questions

What factors may affect the device communication?

- Walls, glasses, or metal materials attenuate the signal significantly between device and phone/hub. It is highly recommended to keep clear range between them for better communication.

Why sometimes I need to "wake up" the sensor?

- For power-saving purposes, the sensor is in a "sleeping" state most of the time and it won't receive any command until it is in an active state.
- Every time when you try to assign the device to a room or link an action for automation, you need to press the reset button shortly to wake it up. The active state will last for 20s and you won't need to wake it up again during the active state.

FCC Radiation Exposure Statement

- FCC ID: 2ATEV-SR4M
- This device complies with Part 15 of the FCC Rules. Operation is subject to the following conditions: (1) this device may not cause harmful interference, and (2) this device must accept any interference received, including interference that may cause undesired operation.



Product Specifications

Model	SR4M
Connectivity	Bluetooth
Power Supply	DC 2.7-3V (2x AAA Batteries)
Power Consumption	≤46uA (standby) ≤25mA (max)
Detection Range	5m, 120°
Low Battery Indication	Yes
Temperature Measurement	-10 °C~ 45 °C
Humidity Measurement	≤85%RH

FCC Radiation Exposure Statement:

This equipment complies with FCC radiation exposure limits set forth for an uncontrolled environment. This equipment should be installed and operated with minimum distance 20cm between the radiator & your body.

NOTE 1: This equipment has been tested and found to comply with the limits for a Class B digital device, pursuant to part 15 of the FCC Rules. These limits are designed to provide reasonable protection against harmful interference in a residential installation. This equipment generates uses and can radiate radio frequency energy and, if not installed and used in accordance with the instructions, may cause harmful interference to radio communications. However, there is no guarantee that interference will not occur in a particular installation. If this equipment does cause harmful interference to radio or television reception, which can be determined by turning the equipment off and on, the user is encouraged to try to correct the interference by one or more of the following measures:

- Reorient or relocate the receiving antenna.
- Increase the separation between the equipment and receiver.
- Connect the equipment into an outlet on a circuit different from that to which the receiver is connected.
- Consult the dealer or an experienced radio/TV technician for help.



User Manual

Radar Motion Sensor | SR4M



Overview

LED Indicators
Red LED (Tampering, Low Battery)
Blue LED (Pairing, Motion Detection)

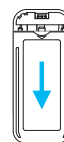

Tampering Alert Switch
Reset Hole

Slide down to open battery cover

STEP 1 Install APP



- Scan the QR code or search "BroadLink BLE" in App Store or Google Play to download and install the free App.
- Account creation is not mandatory to use the App. However, as an option, you can go to "Me" tab to create your account for syncing data between different mobile devices.

STEP 2 Add Device

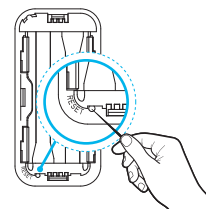

- Tap "Add Device" > "Sensor". Press and hold the reset button for 5s using a needle until the blue LED flashes quickly (pairing mode lasts for 20s).
 - Then click "Add Devices" to let the App scan device to be paired.
 - The device will appear on the App and the blue LED will stop flashing.
- NOTE:** If the device does not appear, try a reset, and add again.

History and Automations

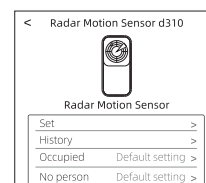

- On device page, you can view the history of motion detection (a BLE gateway/hub is required).
- You can set the delay time for occupation (ex. 20s means the sensor will consider there is no person after 20s when no motion is detected).
- You can also set the automation to trigger scenes when the sensor detects motion or no person (ex. Turn on bulb if motion is detected).

Alert Notifications

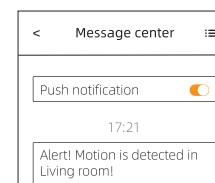

- You can set the alert notification in "Me" > "Message center". If you enable "Push notification", you can also set which sensors are involved for alert. (a BLE gateway/hub is required)
- If all these are set, you can get a push notification on phone when the sensor is triggered (ex. "Alert! Motion is detected in Living room!") and view the history in Message center.

Works with Alexa/Google

- Refer to the manual of gateway/hub to link to Alexa/Google service.
 - After the device is discovered, you can ask Alexa for the status or use the sensor as trigger in Routines.
- NOTE:** It is recommended to use the "One-Click" linking from BroadLink BLE App. If you are trying to enable the skill from Alexa / Google Home App, please copy the authentication code of gateway/hub and paste it in account linking page to complete.

Installation

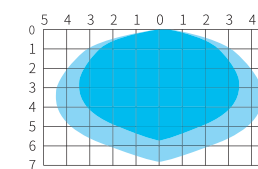

- Try to install it at a place with max coverage for the area with frequent person movement. It is recommended to install it 2-3 meters from floor.
- The below detection range shows high sensitive area with dark color and less sensitive area with light color.



Access product tutorials and manuals from



Official Website



Facebook



YouTube



Twitter

Having issues of using the product?
Please contact us before returning.

✉ support@broadlink.com

We are always be ready to help until you smile :)